

Higher Efficiency, Lower Noise, and More Reliable Products
Powered by Yilida EC Fan Technology.

Zhejiang Yilida Ventilator Co., Ltd.
浙江亿利达风机股份有限公司

Yilida Road, Hengjie, Luqiao District, Taizhou City, Zhejiang, China P.C: 318056
中国浙江台州市路桥区横街亿利达路

Tel : +86 576 82656000 +86 576 82658900
Fax : +86 576 82655758
E-mail : info@yilida.com

Hot Line (全球服务热线) : 400 1135 666 International Trade (国际贸易) : +86 576 82622666 www.yilida.com

Stock Code 股票代码 002686



Yilida
EC Fan
Technology

ZQ Series Centrifugal Fan
ZQ 系列离心风机

Version Number: M201808 The rights of final interpretation of this brochure belongs to Yilida.
© 2018 All Rights Reserved by Yilida

版本号 : M201808 该手册最终解释权归亿利达股份公司所有
© 2018 亿利达拥有版权并保留所有权利

本样本中所述的风机特性, 如尺寸、性能参数等, 本公司保留更改的权利, 恕不另行通知; 如有不明之处, 请来电询问。
This fan features described in the sample, such as size, performance parameters, the Company reserves the right to change without notice; if unknown place, please call us.

Yilida®

The Smart Air

目录

CONTENTS

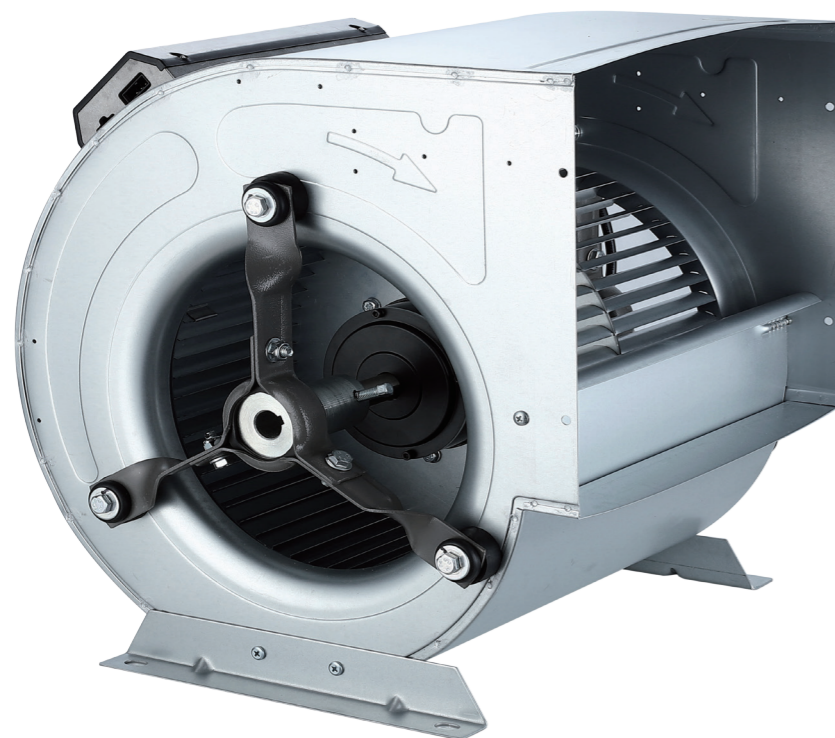

概述

命名方式

产品型式

产品指数

ZQ7-7I

ZQ8-8I

ZQ9-7I

ZQ9-9I

ZQ10-8I

ZQ10-10I

ZQ12-9I

ZQ12-12I

Summary

Nomenclature

Product Features

Product index

ZQ7-7I

ZQ8-8I

ZQ9-7I

ZQ9-9I

ZQ10-8I

ZQ10-10I

ZQ12-9I

ZQ12-12I

4

4

5-9

10

12

13-14

15

16-18

19-20

21-22

23

24

概述

ZQ 系列风机采用直流无刷外转子电机，匹配 SYZ 系列低噪音风机，流量可达到 4737m³/h，静压可达 674Pa，具有效率高、噪音低、调速方便、结构稳定紧凑、可靠性高等特点，是管道式空调机组、VAV 变风量空调系统、YAH 系列吊顶式空气处理机组等暖通空调和净化设备理想的配套产品。

Summary

ZQ series fans consist of external rotor BLDC motor and low noise SYZ series fans. The air flow volume could reach 4737m³/h, and the static pressure could reach 674Pa. It has the advantage of high efficiency, low noise, convenient speed control, compact structure, and high reliability. It is the ideal equipment for the tube type units, VAV variable air volume system, AHU air handling units, and other HVAC system.

命名方式

Nomenclature

ZQ 10 - 8 I (500W) LG 180° FL

- | | |
|------------------------|------------------------------------|
| 带出风法兰 FL | With outlet flange FL |
| 不带出风法兰(缺省) | Without air outlet flange(Default) |
| 出风方向 | Wind direction |
| 0°、90°、180°、270° 4 个角度 | 0°、90°、180°、270° |
| 不带支板(缺省) | Non supporting plate (Default) |
| 左旋 LG(缺省) | Left-handed LG(Default) |
| 右旋 RG | Right-handed RG |
| 电机功率 | Motor power |
| 改型标记(I II III) | Mark of revision(I II III) |
| 叶轮名义宽度 (inch) | Width Of Impeller (inch) |
| 叶轮名义直径 (inch) | Diameter Of Impeller (inch) |
| 整机型号 | Whole machine model |

产品型式

旋向

ZQ 系列风机可分为左旋 (LG) 和右旋 (RG) 两种旋转方式，从电机出线端正视，叶轮顺时针旋转的称为右旋风机，逆时针旋转的称为左旋风机。

Product Features

Rotation

ZQ series fans can be divided into left-handed (LG) and right-handed (RG) two kinds of rotation methods, from the motor outlet end face, the clockwise rotation of the impeller is called the right-hand fan, anti-clockwise rotation is called the left-hand fan.

图 1 (Fig. 1)

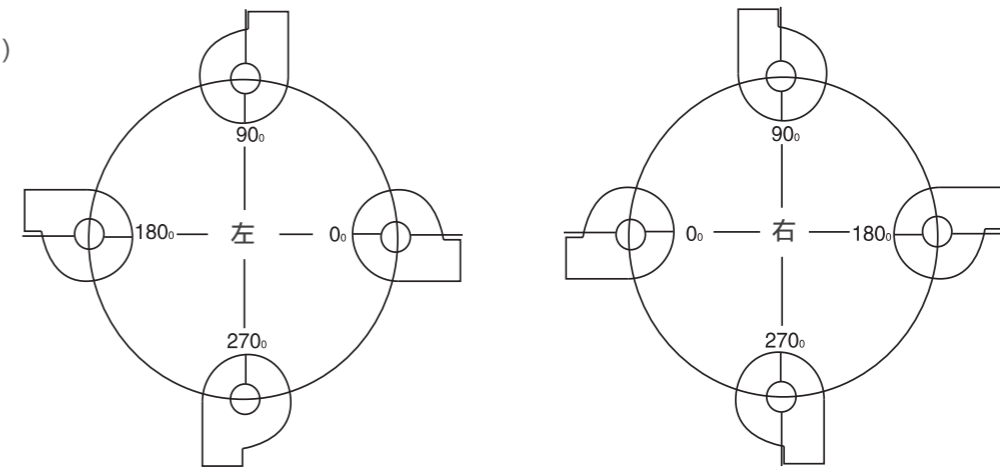

左旋 / 右旋示意图 Left-hand/right-hand sketch

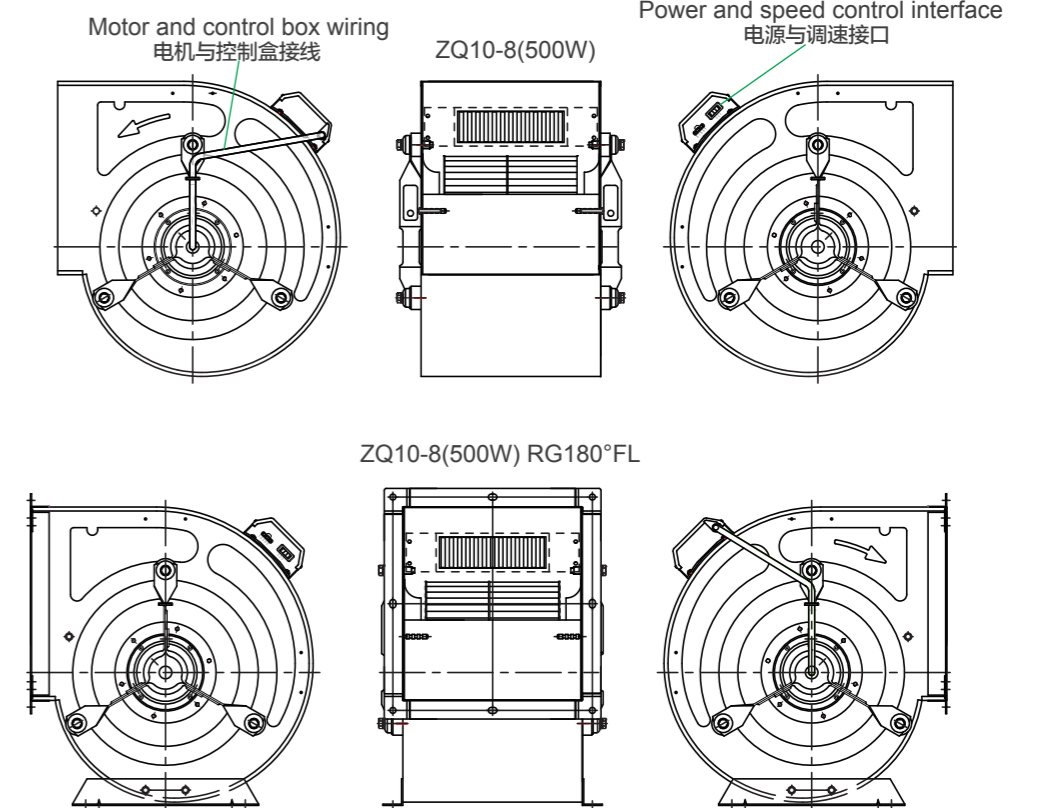

产品型式

ZQ 系列风机主要由风机部、电机部、控制部、法兰组成。

1. 风机部

蜗壳采用热镀锌钢板制造，侧板具有符合空气动力学的外形，进风口整体拉伸成型，蜗板采用点焊方式与侧板连成一体。前向多翼叶轮采用热镀锌板钢板制成，叶片设计成符合空气动力学的特定形状，使得效率最高，噪声最低。叶片用铆爪固定在中盘及端圈上，在最大功率连续运转时，叶轮将具备足够的刚度。所有叶轮和电机进行整体动平衡测试内控精度达 G2.5 级 (ANSI/AMCA-204)；支板采用热镀锌板制成，独特加强工艺保证足够的强度，支板安装角度可以根据用户的不同需求进行调整，以满足用户不同方向的安装需求。

2. 电机部

采用永磁体提供励磁，使电机结构较为简单，体积小，重量轻。电机的气隙磁场趋于正弦，减少电机转矩脉动，大幅降低电机振动和噪音，且具有良好的启动、调速性能，使用范围广，通用性强。

3. 控制部

采用无位置 FOC 控制算法，软启动，即插即用。具有专利技术的方式，将控制部分嵌在蜗壳风道内，采用自冷风。

Product Features

ZQ series fans are mainly composed of fan, motor, control and flange.

1. Fan Department

The housing is made of hot galvanized steel sheet. The side plates include inlet cones that are designed with the best aerodynamics for inlet condition. The scroll is fixed to the side plates by spot welding. The wheel is made of hot galvanized steel sheet. The forward curved blades are designed with the advanced aerodynamics profile to achieve the highest efficiency and the lowest noise level. The impeller is fixed on the center plate and on the end ring with riveting grip press. The impeller is constructed with maximum strength that endures the continuous operation with maximum power. All impellers and motor are overall balanced according to the ANSI/AMCA-204 standard. Yilida's internal standard is G2.5 or higher for wheel and motor balancing. The mounting feet are made of galvanized steel sheet with unique technics to ensure the sufficient strength. And the mounting angle of the mounting feet can be adjusted according to the needs of the users.

2. Motor Department

Replace the traditional wire-wound windings by the excitation part of permanent magnet, and make the motor structure simple, small and light. The motor air-gap magnetic field tends to sine waves. This can reduce the motor torque fluctuation, significantly reducing vibration and noise, with good startup, speed performance, and wide range of use, and strong versatility.

3. Control department

Use sensorless field oriented control, soft start. Plug and play. The self cooling structure mode with technology patent is to embed the control part in the air duct with in the housing.

产品型式

4. 法兰

法兰采用热镀锌钢板制造，法兰与壳体的连接采用 TOX 免焊工艺，外观精美并具有足够的刚度和强度。法兰口尺寸型式参照图 2 所示。

图 2 (Fig 2)

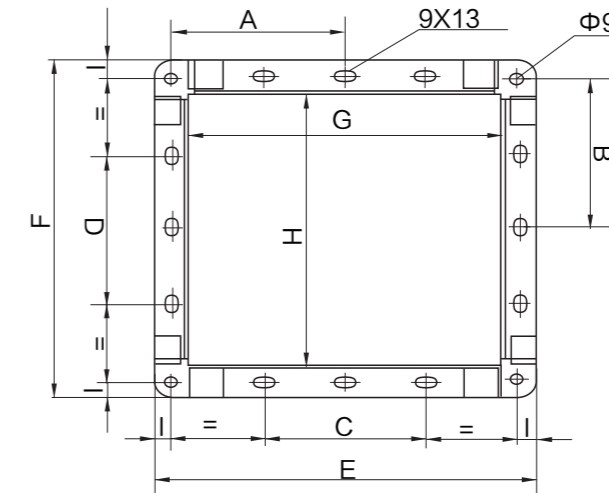

4. Flange

The flange is made of galvanized steel. The connections of the flange components to the scroll are made using a TOX non-welding process. This maintains a good flange appearance while also providing sufficient strength and rigidity. The dimensions and type of flange are shown in Fig2.

型号 Type	7-7I	8-8I	9-7I	9-9I	10-8I	10-10I	12-9I	12-12I
A	126	153.5	126	159	150	180.5	—	—
B	114	138	141	141	160.5	160.5	—	—
C	—	—	—	—	—	—	125	150
D	—	—	—	—	—	—	140	140
E	272	327	272	338	326	387	365	457
F	248	296	302	302	347	347	397	397
G	232	287	232	298	270	331	309	395
H	208	256	262	262	291	291	341	341
I	10	10	10	10	13	13	13	13

注：表格和外形尺寸的单位为 mm。

Note: the size unit in the form and overall size are mm.

5. 技术特点

无极调速 :0-10V Max10mA、FG 反馈
 保护: 电流保护、过温保护、过压保护、堵转保护
 泄露电流: < 3.5 (mA)
 温度范围: -20 ~ 45(°C)
 绝缘等级: B
 防护等级: IP20
 认证: CCC、CE

5. Technical characteristics

Stepless speed 0-10V Max10mA、FG Feedback
 Protection: Overcurrent protectio、Overtemperature protection、Overvoltage protection、Plugging protection
 Leakage current: < 3.5 (mA)
 Temperature range: -20 ~ 45(°C)
 Insulation class: B
 Protection grade: IP20
 Authenticate: CCC、CE

6. 接线图

6. Wiring diagram

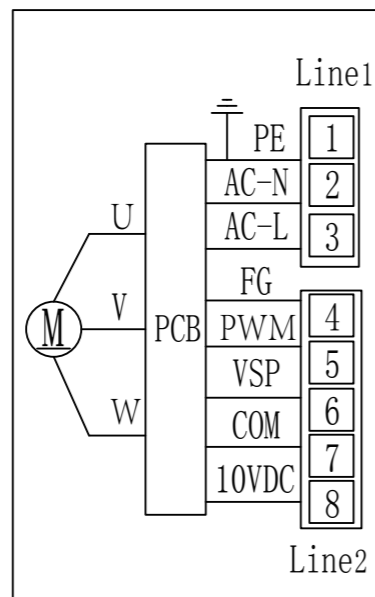

7. 接线说明

7. Wiring instructions

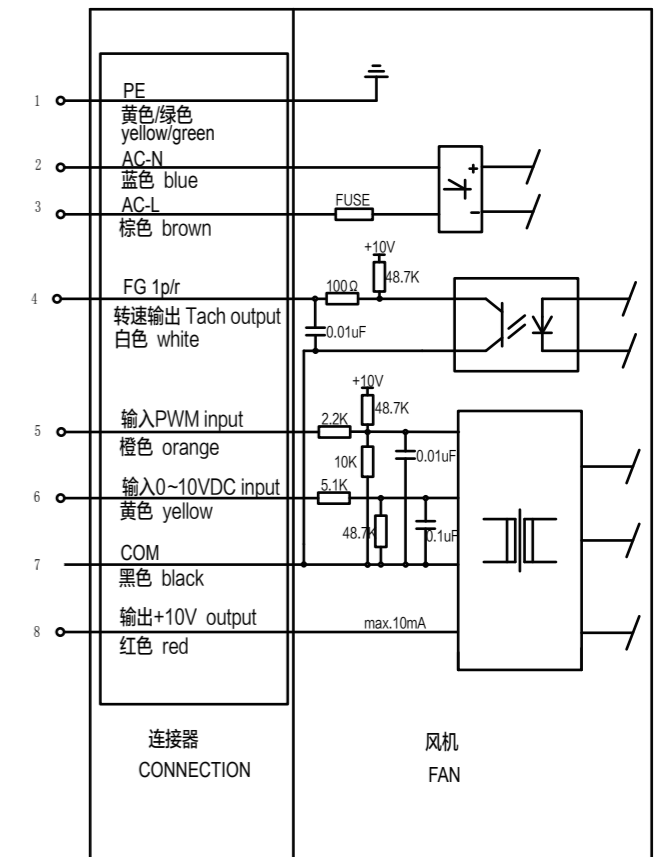
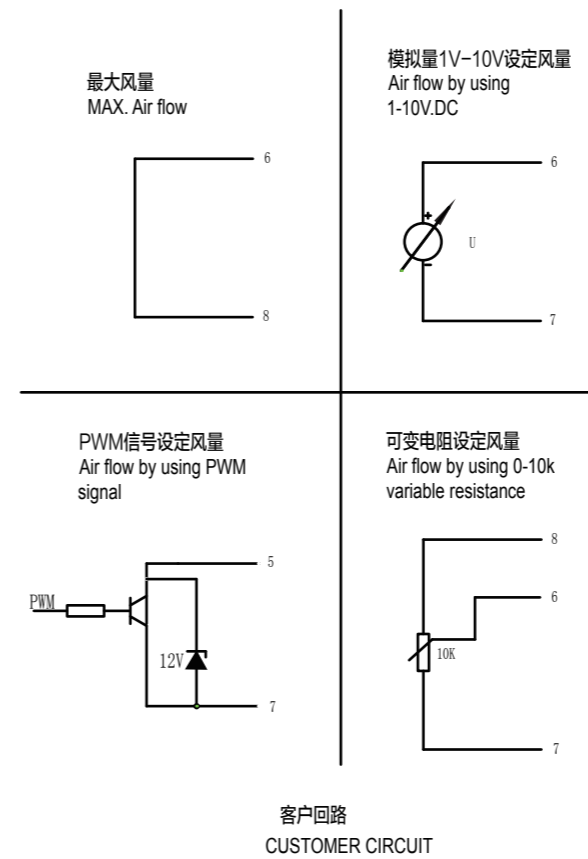

产品指数

Index

风机型号 Fan model	叶轮型号 Impeller model	电机型号 motor model	转速范围 Rotational speed range	最大风量 Maximum air volume	最大静压 Maximum static pressure	最高全压效率 Highest total pressure efficiency
ZQ7-7I(375W)	7-7	YZWWSL-375-11	450~1350rpm	2554	244	50.6
ZQ8-8I(375W)	8-8	YZWWSL-375-11	450~1350rpm	3038	356	52.1
ZQ8-8I(500W)	8-8	YZWWSL-500-11	450~1350rpm	3218	351	49.4
ZQ9-7I(375W)	9-7	YZWWSL-375-11	450~1350rpm	2662	472	58.3
ZQ9-9I(375W)	9-9	YZWWSL-375-11	450~1200rpm	3030	361	55.3
ZQ9-9I(500W)	9-9	YZWWSL-500-11	450~1350rpm	3080	450	53.7
ZQ9-9I(750W)	9-9	YZWWSL-750-11	450~1350rpm	4226	458	59.5
ZQ10-8I(500W)	10-8	YZWWSL-500-11	450~1350rpm	3326	511	57.4
ZQ10-8I(750W)	10-8	YZWWSL-750-11	450~1350rpm	4217	522	59.9
ZQ10-10I(500W)	10-10	YZWWSL-500-11	450~1200rpm	3801	360	54.6
ZQ10-10I(750W)	10-10	YZWWSL-750-11	450~1350rpm	4018	560	59.8
ZQ12-9I(750W)	12-9	YZWWSL-750-11	450~1350rpm	4577	674	58.6
ZQ12-12I(750W)	12-12	YZWWSL-750-11	450~1350rpm	4737	581	55.8



ZQ7-7I(375W)

电机: YZWWSL-375-11
电压范围: 1 ~ 220-240VAC
频率: 50/60Hz
最大转速: 1350rpm
额定电流: 3.2A
重量: 11.3Kg
最大输入功率: 451W

Motor: YZWWSL-375-11
Voltage range: 1 ~ 220-240VAC
Frequency: 50/60Hz
Max.Speed: 1350rpm
Rated current: 3.2A
Weight: 11.3Kg
Max.Power input: 451W

性能曲线

Performance Curve

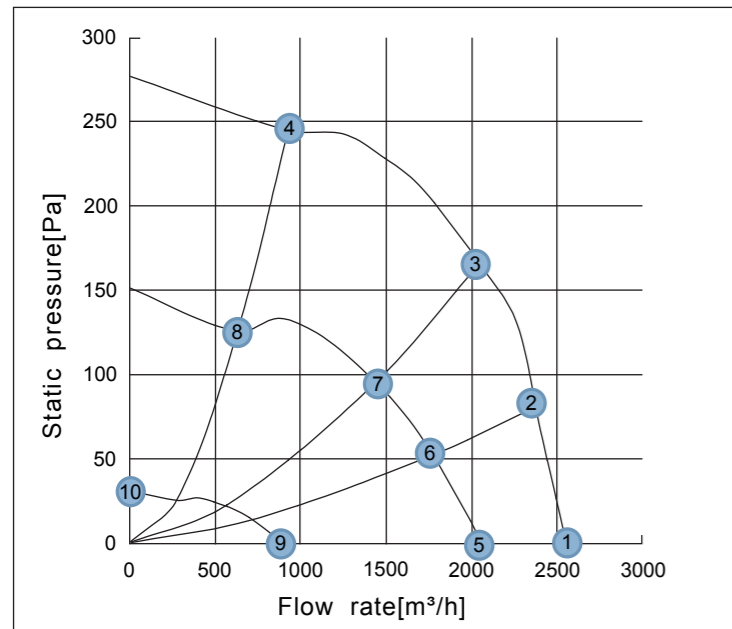

	n[rpm]	Q(m³/h)	P _{st} [Pa]	P _i [W]	I[A]	L _{WA} [dB(A)]	η _{TL} [%]
1	1350	2554	0	451	3.43	80.2	20.4
2	1350	2330	80	440	3.35	79.7	30
3	1350	2046	165	370	2.92	79.5	38.1
4	1350	932	244	148	1.26	76.6	45.6
5	1000	2060	0	238	1.93	73.1	20.3
6	1000	1773	52	192	1.59	72.2	29.4
7	1000	1441	95	146	1.25	71.2	37.2
8	1000	635	125	66	0.61	65.1	35.6
9	450	895	0	32	0.33	57.2	12.5
10	450	0	31	26	0.28	51.3	0

外形及安装尺寸

Overall Dimensions

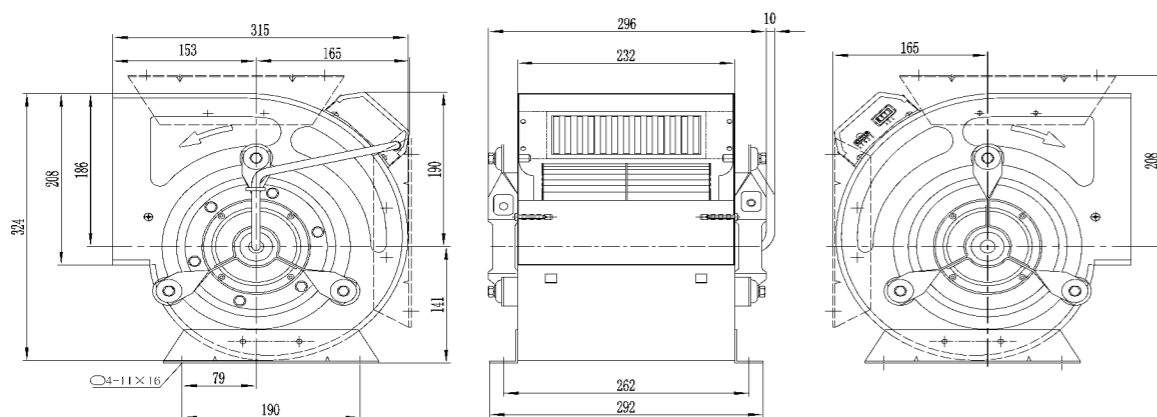

ZQ8-8I(375W)

电机: YZWWSL-375-11
电压范围: 1 ~ 220-240VAC
频率: 50/60Hz
最大转速: 1350rpm
额定电流: 3.2A
重量: 13Kg
最大输入功率: 490W

Motor: YZWWSL-375-11
Voltage range: 1 ~ 220-240VAC
Frequency: 50/60Hz
Max.Speed: 1350rpm
Rated current: 3.2A
Weight: 13Kg
Max.Power input: 490W

性能曲线

Performance Curve

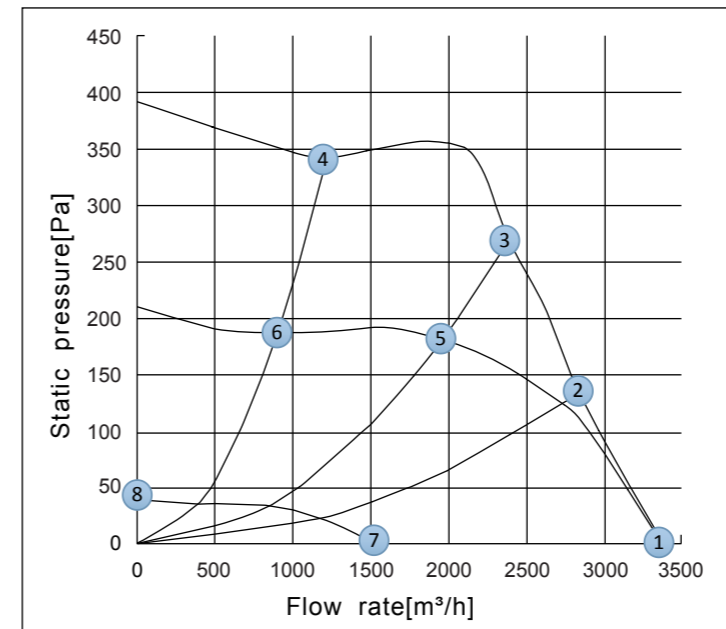

	n[rpm]	Q(m³/h)	P _{st} [Pa]	P _i [W]	I[A]	L _{WA} [dB(A)]	η _{TL} [%]
1	843	3038	0	412	3.17	80.1	16.4
2	1041	2847	134	487	3.73	80.6	33.3
3	1220	2392	269	481	3.67	78.5	44.3
4	1350	1220	342	278	2.21	75.0	43.5
5	1000	1905	184	298	2.38	73.8	45.8
6	1000	880	187	112	0.93	68.2	42.3
7	450	1540	0	61	0.57	65.1	14.4
8	450	0	40	18	0.216	52.9	0

外形及安装尺寸

Overall Dimensions

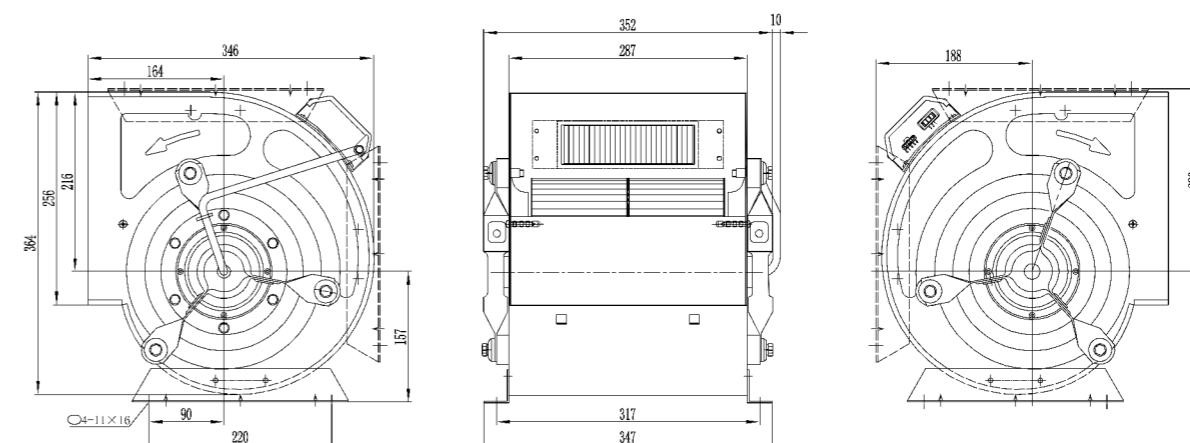



ZQ8-8I(500W)

电机: YZWWSL-500-11
电压范围: 1 ~ 220-240VAC
频率: 50/60Hz
最大转速: 1350rpm
额定电流: 4A
重量: 13.4Kg
最大输入功率: 650W

Motor: YZWWSL-500-11
Voltage range: 1 ~ 220-240VAC
Frequency: 50/60Hz
Max.Speed: 1350rpm
Rated current: 4A
Weight: 13.4Kg
Max.Power input: 650W

性能曲线

Performance Curve

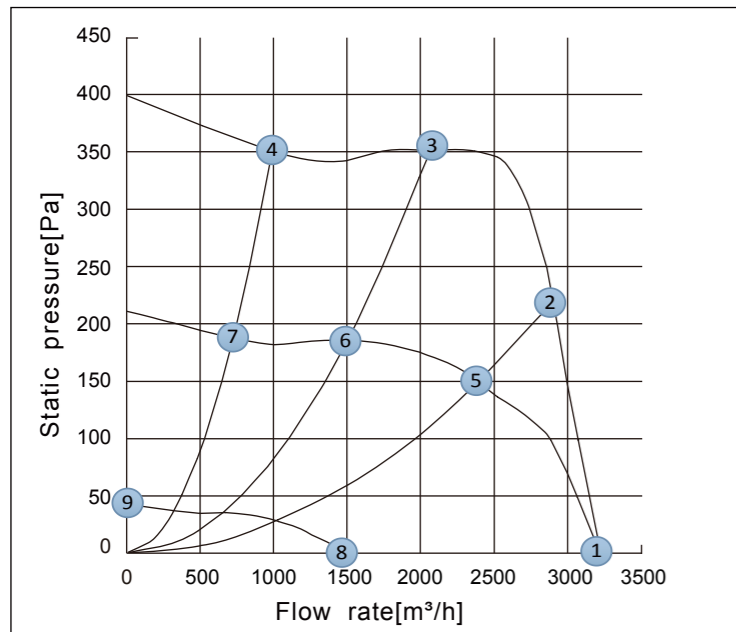

	n[rpm]	Q(m³/h)	P _{st} [Pa]	P _i [W]	I[A]	L _{WA} [dB(A)]	η _{tl} [%]
1	903	3218	0	495	3.75	80.5	16
2	1200	2900	219	597	4.4	80.1	39
3	1350	2071	351	470	3.56	77.3	46.9
4	1350	992	350	252	2.05	73.9	38.8
5	1000	2400	150	354.6	2.71	76.1	37.6
6	1000	1500	184.5	193.2	1.59	70.6	44.1
7	1000	707	177.4	121.6	1.08	67.6	29.4
8	450	1479	0	62.6	0.59	64.0	12.2
9	450	0	42.5	24	0.256	52.7	0

外形及安装尺寸

Overall Dimensions

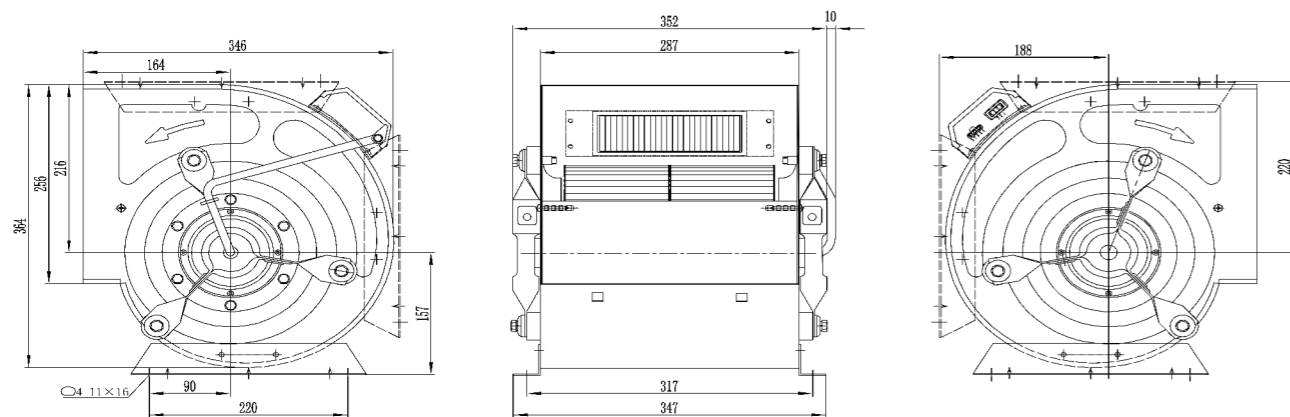

ZQ9-7I(375W)

电机: YZWWSL-375-11
电压范围: 1 ~ 220-240VAC
频率: 50/60Hz
最大转速: 1350rpm
额定电流: 3.2A
重量: 13.1Kg
最大输入功率: 498W

Motor: YZWWSL-375-11
Voltage range: 1 ~ 220-240VAC
Frequency: 50/60Hz
Max.Speed: 1350rpm
Rated current: 3.2A
Weight: 13.1Kg
Max.Power input: 498W

性能曲线

Performance Curve

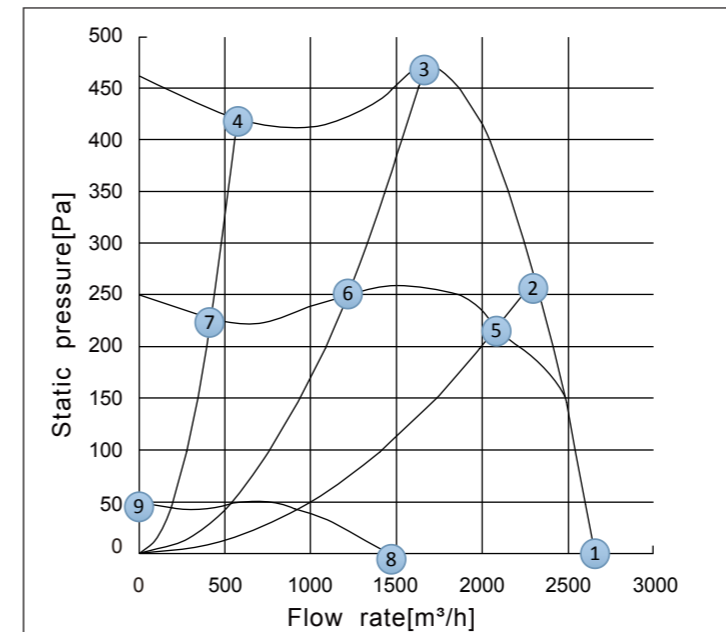

	n[rpm]	Q(m³/h)	P _{st} [Pa]	P _i [W]	I[A]	L _{WA} [dB(A)]	η _{tl} [%]
1	793	2662	0	382.5	2.97	77.4	17.2
2	1110	2305.8	263.7	498.2	3.79	78.1	42.3
3	1350	1677.5	472	123.2	3.23	75.7	55.6
4	1350	580	419.5	18.5	1.56	73.8	36.6
5	1000	2100	218.3	472	2.86	76.1	33.8
6	1000	1223	251	178	1.52	69.0	51.5
7	1000	430	231	93	0.82	67.2	30.1
8	450	1467.6	0	68.6	0.632	64.8	16
9	450	0	49.4	18.3	0.205	54.9	0

外形及安装尺寸

Overall Dimensions

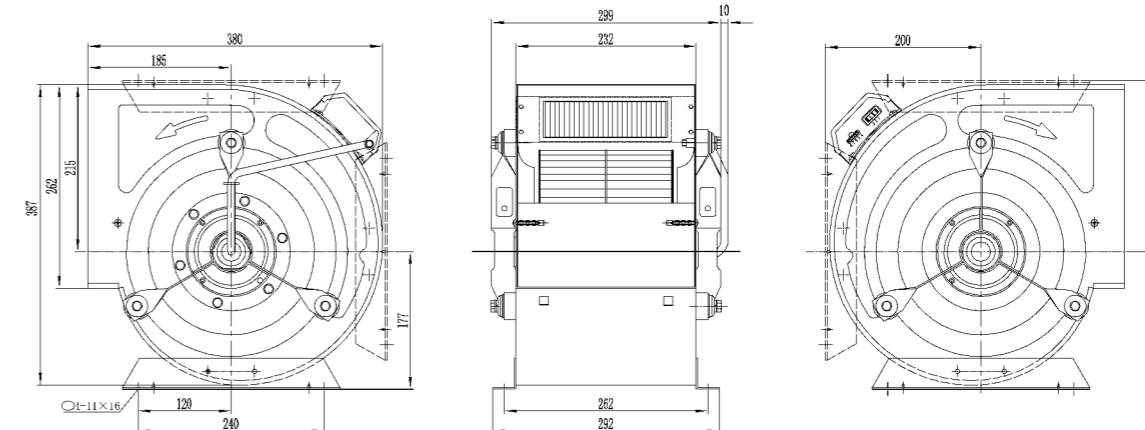



ZQ9-9I(375W)

电机: YZWWWSL-375-11
电压范围: 1 ~ 220-240VAC
频率: 50/60Hz
最大转速: 1200rpm
额定电流: 3.2A
重量: 14.1Kg
最大输入功率: 493W

Motor: YZWWWSL-375-11
Voltage range: 1 ~ 220-240VAC
Frequency: 50/60Hz
Max.Speed: 1200rpm
Rated current: 3.2A
Weight: 14.1Kg
Max.Power input: 493W

性能曲线

Performance Curve

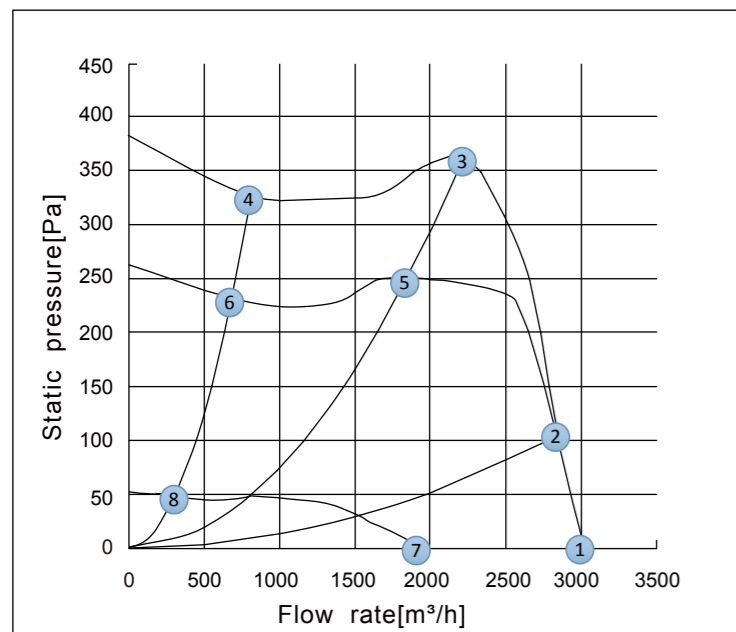

	n[rpm]	Q(m³/h)	P _{st} [Pa]	P _i [W]	I[A]	L _{WA} [dB(A)]	η _{tl} [%]
1	703	3030	0	363	2.75	76.8	16
2	829	2850	103	416	3.15	76.1	31
3	1200	2230	362	483.12	3.66	74.4	51.4
4	1200	821	326	211	1.6	72.1	35.8
5	1000	1700	252	263	2.1	68.9	50.6
6	1000	650	235	119	1.05	67.9	36.2
7	450	1945	0	91.8	0.81	66.9	17
8	450	0	51.8	20.3	0.215	52.5	0

外形及安装尺寸

Overall Dimensions

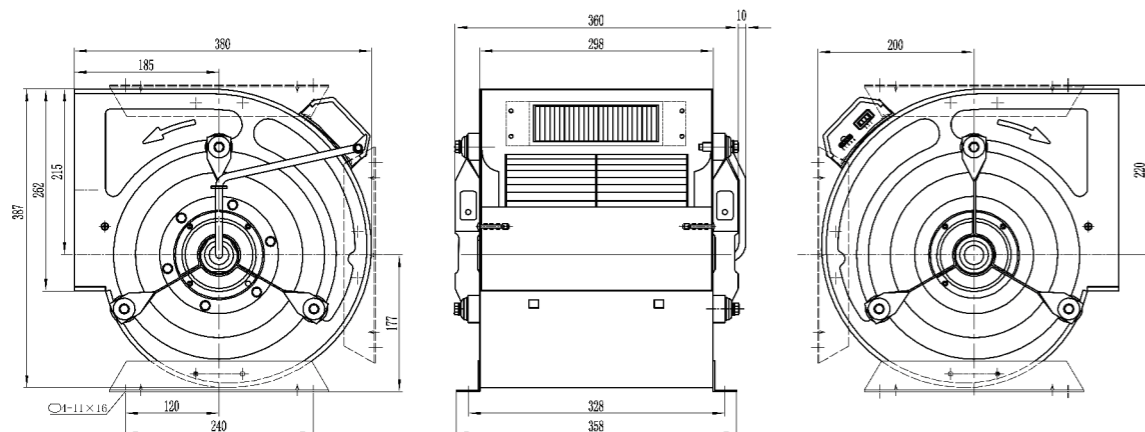

ZQ9-9I(500W)

电机: YZWWWSL-500-11
电压范围: 1 ~ 220-240VAC
频率: 50/60Hz
最大转速: 1350rpm
额定电流: 4A
重量: 14.4Kg
最大输入功率: 656W

Motor: YZWWWSL-500-11
Voltage range: 1 ~ 220-240VAC
Frequency: 50/60Hz
Max.Speed: 1350rpm
Rated current: 4A
Weight: 14.4Kg
Max.Power input: 656W

性能曲线

Performance Curve

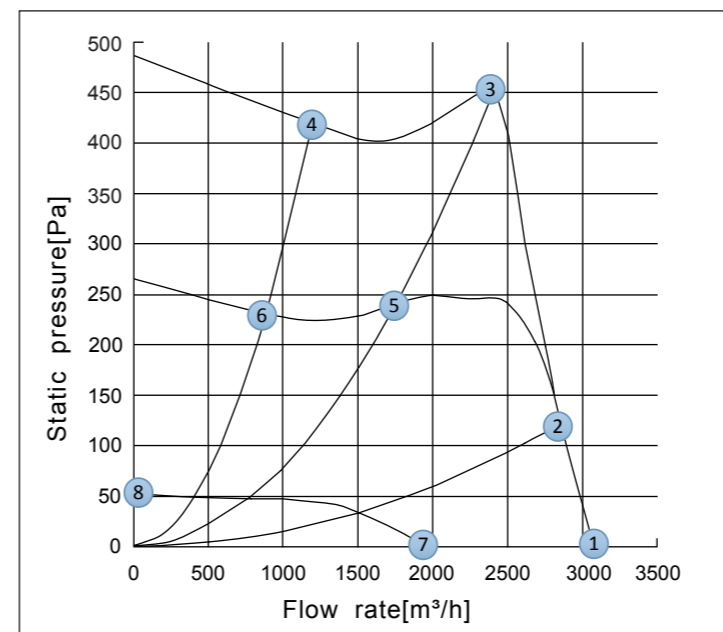

	n[rpm]	Q(m³/h)	P _{st} [Pa]	P _i [W]	I[A]	L _{pA} [dB(A)]	η _{tl} [%]
1	683	3080	0	347	2.72	76.7	17.8
2	835	2863	120	415	3.16	75.8	35.4
3	1350	2410	451	656	4.83	78.2	51.2
4	1350	1197	419	330	2.62	75.1	43.9
5	1000	900	235	150	1.23	68.5	35
6	1000	1756	240	256	2.1	71.3	50.1
7	450	1940	0	95	0.85	66.8	16.1
8	450	0	52	26	0.27	51.9	0

外形及安装尺寸

Overall Dimensions

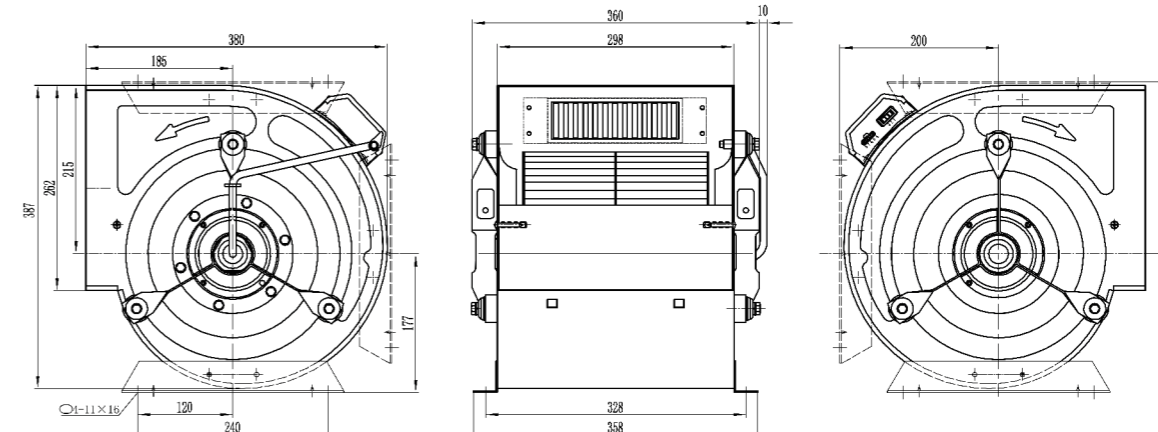



ZQ9-9I(750W)

电机: YZWWSL-750-11
电压范围: 1 ~ 220-240VAC
频率: 50/60Hz
最大转速: 1350rpm
额定电流: 5.8A
重量: 17.4Kg
最大输入功率: 1070W

Motor: YZWWSL-750-11
Voltage range: 1 ~ 220-240VAC
Frequency: 50/60Hz
Max.Speed: 1350rpm
Rated current: 5.8A
Weight: 17.4Kg
Max.Power input: 1070W

性能曲线

Performance Curve

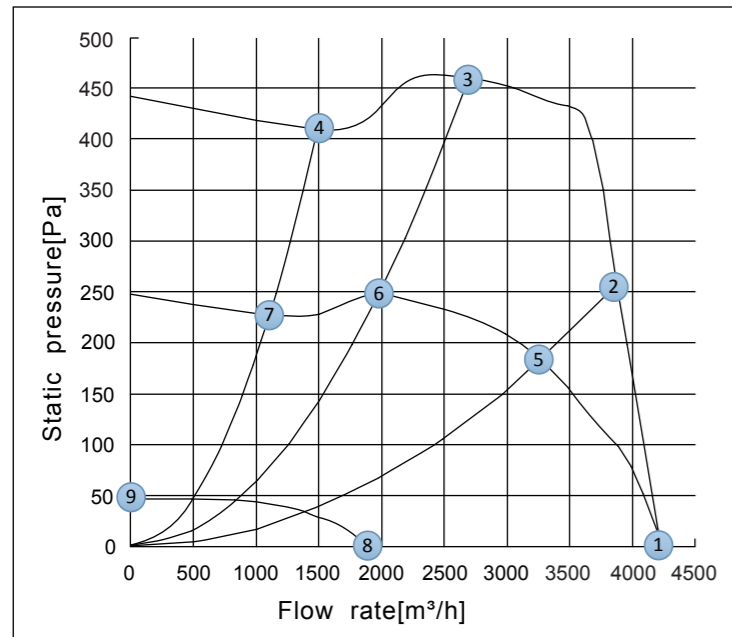

	n[rpm]	Q(m³/h)	P _{st} [Pa]	P _i [W]	I[A]	LWA[dB(A)]	η _{tl} [%]
1	940	4247	0	810	5.8	84.2	19.5
2	1177	3875	256	973	6.85	83.7	40.9
3	1350	2709	459	700	5	79.7	56.6
4	1350	1505	409	373	2.9	75.6	47.7
5	1000	3280	183	570	4.26	79.9	42
6	1000	1975	244	284	2.23	72.2	53.1
7	1000	1130	230	170	1.43	69.1	44.3
8	450	1910	0	85	0.76	65.4	17.2
9	450	0	48	20	0.23	52.2	0

外形及安装尺寸

Overall Dimensions

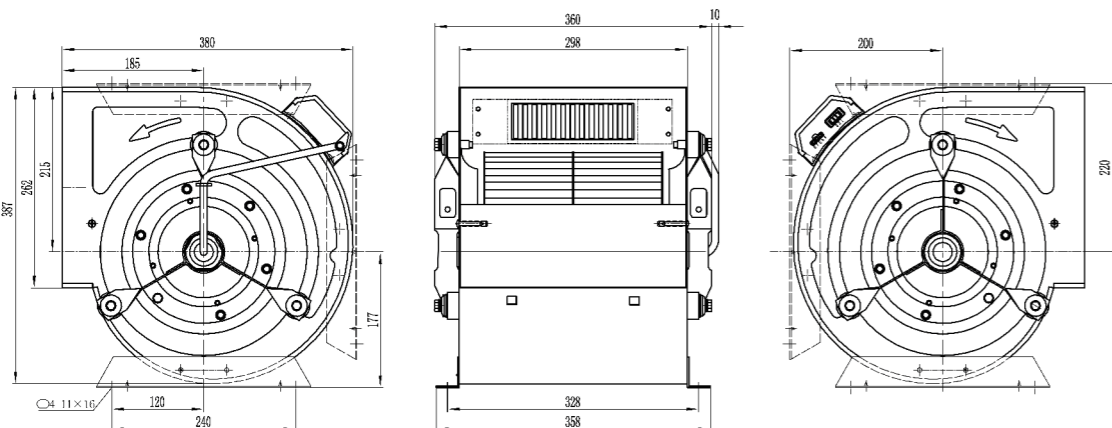

ZQ10-8I(500W)

电机: YZWWSL-500-11
电压范围: 1 ~ 220-240VAC
频率: 50/60Hz
最大转速: 1350rpm
额定电流: 4A
重量: 15.6Kg
最大输入功率: 595W

Motor: YZWWSL-500-11
Voltage range: 1 ~ 220-240VAC
Frequency: 50/60Hz
Max.Speed: 1350rpm
Rated current: 4A
Weight: 15.6Kg
Max.Power input: 595W

性能曲线

Performance Curve

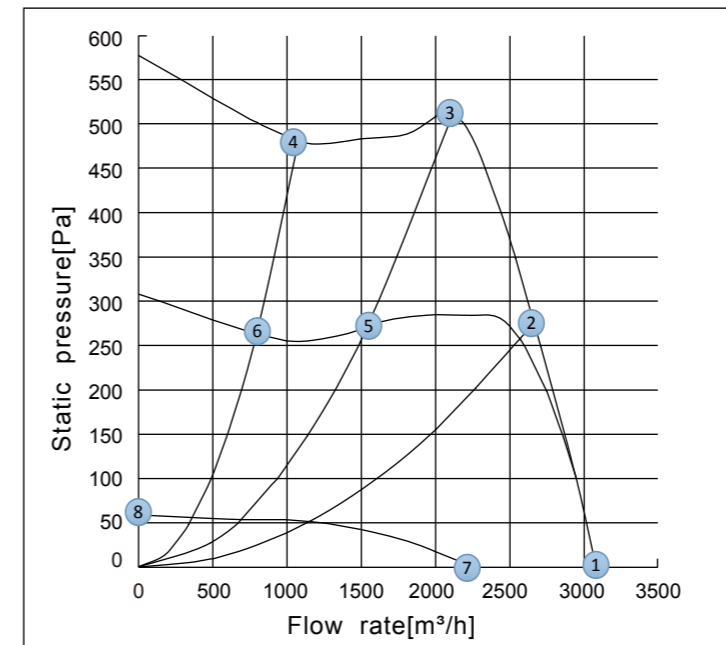

	n[rpm]	Q(m³/h)	P _{st} [Pa]	P _i [W]	I[A]	LWA[dB(A)]	η _{tl} [%]
1	650	3326	0	404.7	3.12	78.6	19.4
2	1000	2665	274	486.6	3.66	76.7	50.3
3	1350	2124	511	595	4.41	77.5	54.6
4	1350	1085	480	336	2.62	76.5	44.3
5	1000	1550	272	241	1.97	70.9	52
6	1000	800	261	152	1.25	69.8	39
7	450	2257	0	120	1.05	70.3	20.5
8	450	0	59.6	27	0.28	56.0	0

外形及安装尺寸

Overall Dimensions

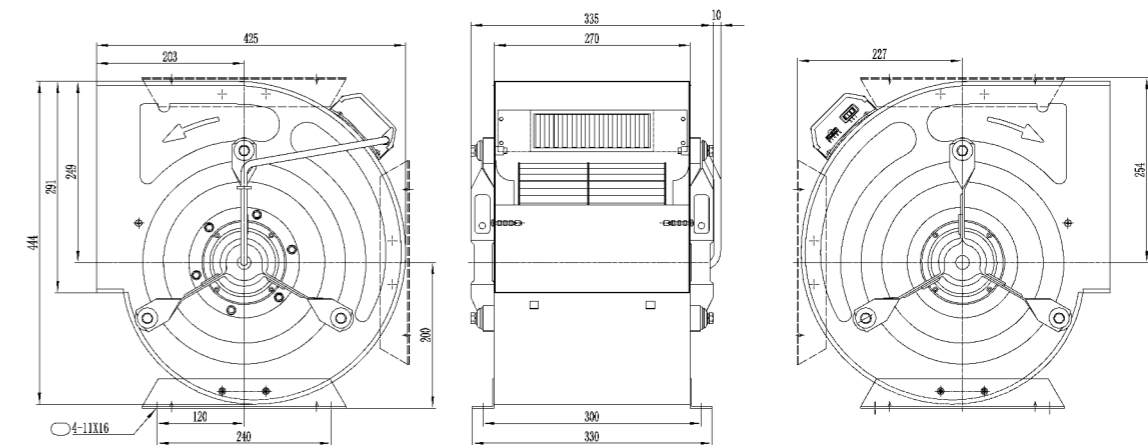



ZQ10-8I(750W)

电机: YZWWSL-750-11
电压范围: 1 ~ 220-240VAC
频率: 50/60Hz
最大转速: 1350rpm
额定电流: 5.8A
重量: 18.8Kg
最大输入功率: 1047W

Motor: YZWWSL-750-11
Voltage range: 1 ~ 220-240VAC
Frequency: 50/60Hz
Max.Speed: 1350rpm
Rated current: 5.8A
Weight: 18.8Kg
Max.Power input: 1047W

性能曲线

Performance Curve

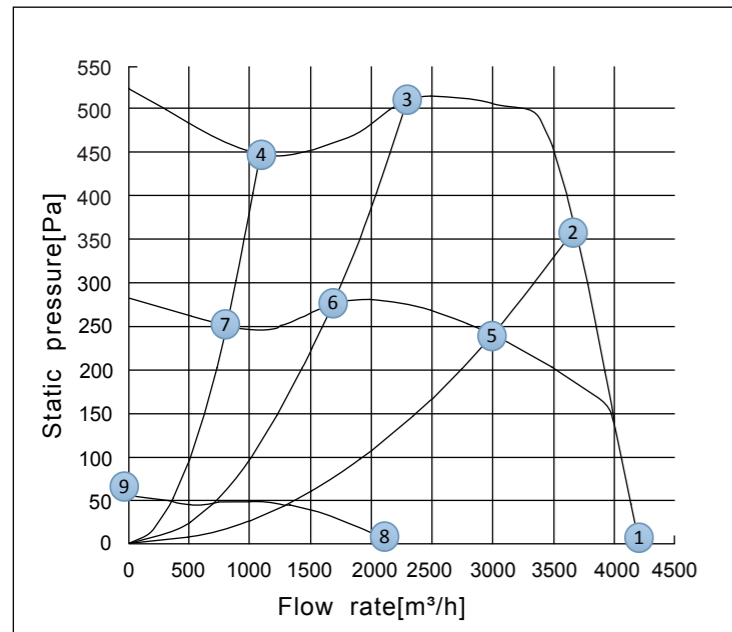

	n[rpm]	Q(m³/h)	P _{st} [Pa]	P _i [W]	I[A]	LWA[dB(A)]	η _{tl} [%]
1	845	4218	0	748	5.42	82.9	21.7
2	1223	3680	360	1026	7.18	82.7	47.3
3	1350	2309	510	634	4.65	78.4	57.1
4	1350	1097	447	335	2.7	76.1	41.5
5	1000	3000	240	538	4	76.5	48
6	1000	1700	277	270	2	72.8	50
7	1000	800	246	158	1.32	70.5	35
8	450	2188	0	110	0.96	69.2	20.4
9	450	0	55.8	24.4	0.262	53.1	0

外形及安装尺寸

Overall Dimensions

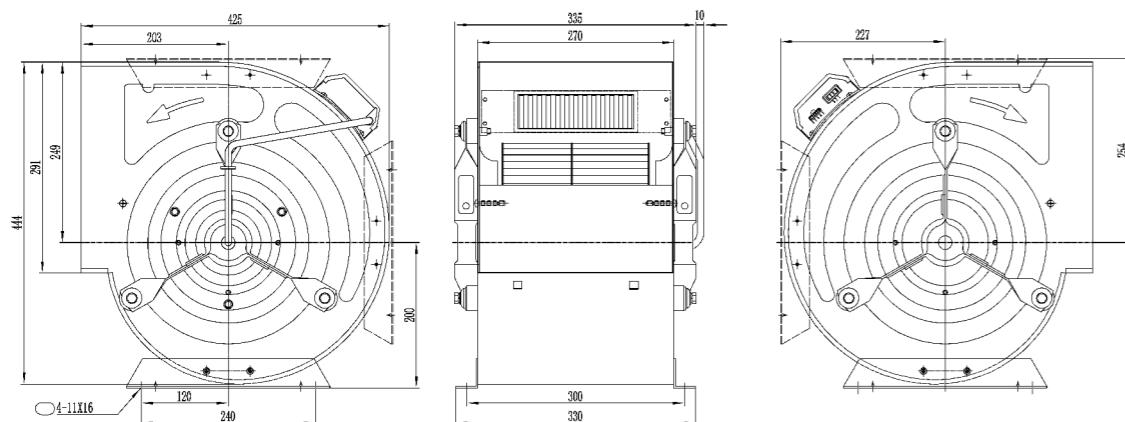

ZQ10-10I(500W)

电机: YZWWSL-500-11
电压范围: 1 ~ 220-240VAC
频率: 50/60Hz
最大转速: 1200rpm
额定电流: 4A
重量: 16Kg
最大输入功率: 600W

Motor: YZWWSL-500-11
Voltage range: 1 ~ 220-240VAC
Frequency: 50/60Hz
Max.Speed: 1200rpm
Rated current: 4A
Weight: 16Kg
Max.Power input: 600W

性能曲线

Performance Curve

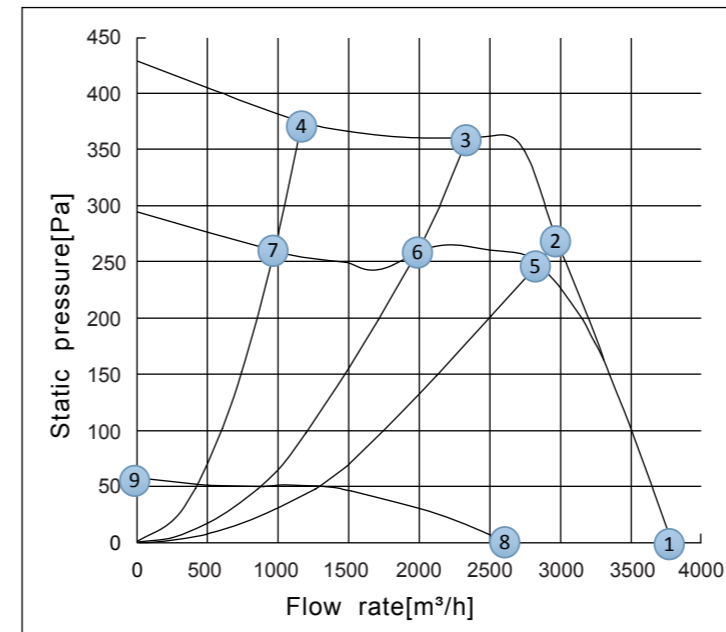

	n[rpm]	Q(m³/h)	P _{st} [Pa]	P _i [W]	I[A]	LWA[dB(A)]	η _{tl} [%]
1	651	3801	0	369	2.92	80.4	21
2	1198	2360	352	486	3.65	76.6	52.5
3	1045	2974	269	546	4.09	79.1	48.5
4	1200	1180	374	314	2.53	74.4	39.7
5	1000	2850	247	497	3.76	78.2	45.7
6	1000	2000	260	338	2.63	72.8	46
7	1000	1000	268	215	1.75	70.4	35
8	450	2626	0	129	1.11	71.7	20.2
9	450	0	57.6	29.6	0.32	60.7	0

外形及安装尺寸

Overall Dimensions

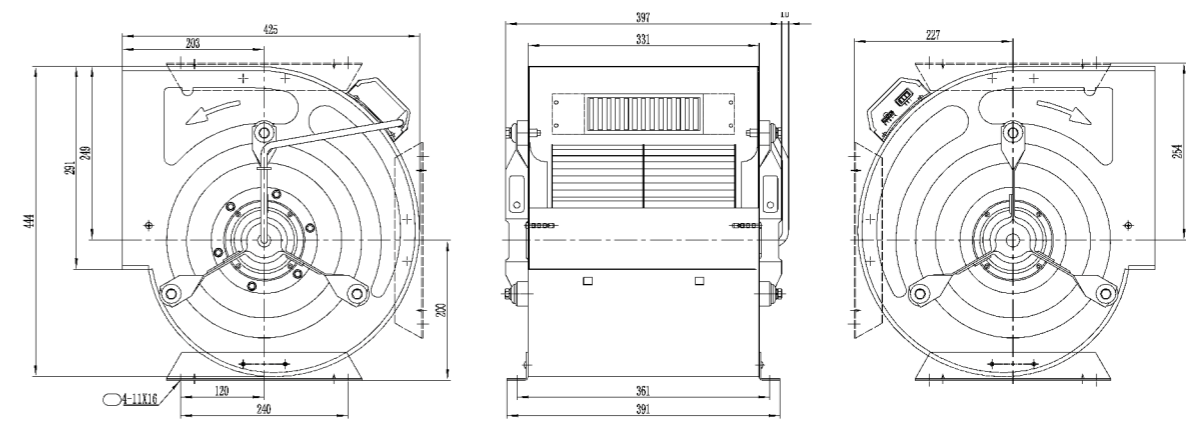



ZQ10-10(750W)

电机: YZWWSL-750-11
电压范围: 1 ~ 220-240VAC
频率: 50/60Hz
最大转速: 1350rpm
额定电流: 5.8A
重量: 19.7Kg
最大输入功率: 1090W

Motor: YZWWSL-750-11
Voltage range: 1 ~ 220-240VAC
Frequency: 50/60Hz
Max.Speed: 1350rpm
Rated current: 5.8A
Weight: 19.7Kg
Max.Power input: 1090W

性能曲线

Performance Curve

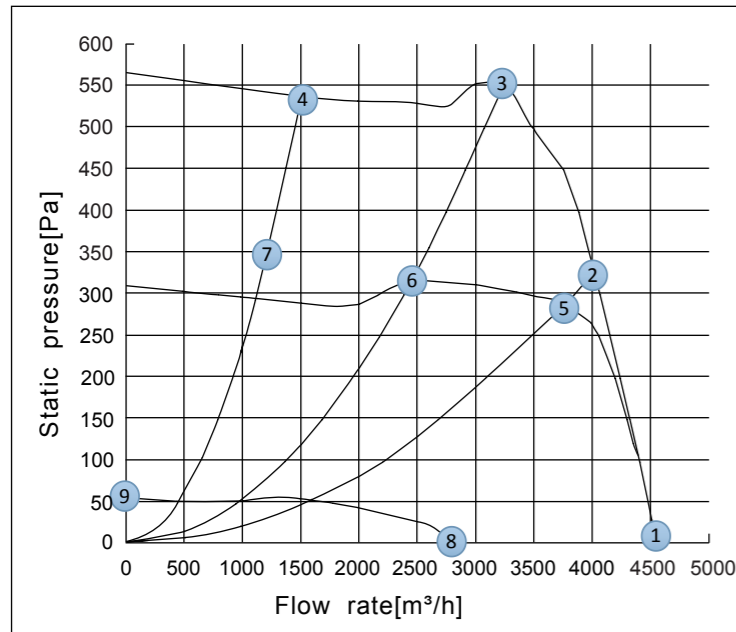

	n[rpm]	Q(m³/h)	P _{st} [Pa]	P _i [W]	I[A]	L _{WA} [dB(A)]	η _{IL} [%]
1	770	4550	0	656	4.8	84.4	30
2	1056	4018	325	906	6.4	80.3	50.5
3	1350	3251	550	1015	7.1	76.2	57
4	1350	1520	536	500	3.77	77.0	46.3
5	1000	3750	283	730	5.33	78.2	51.8
6	1000	2480	320	424	3.24	71.8	57
7	1000	1120	291	227	1.9	70.4	41
8	450	2815	0	151	1.27	71.7	21.6
9	450	0	54	26	0.28	66.7	0

外形及安装尺寸

Overall Dimensions

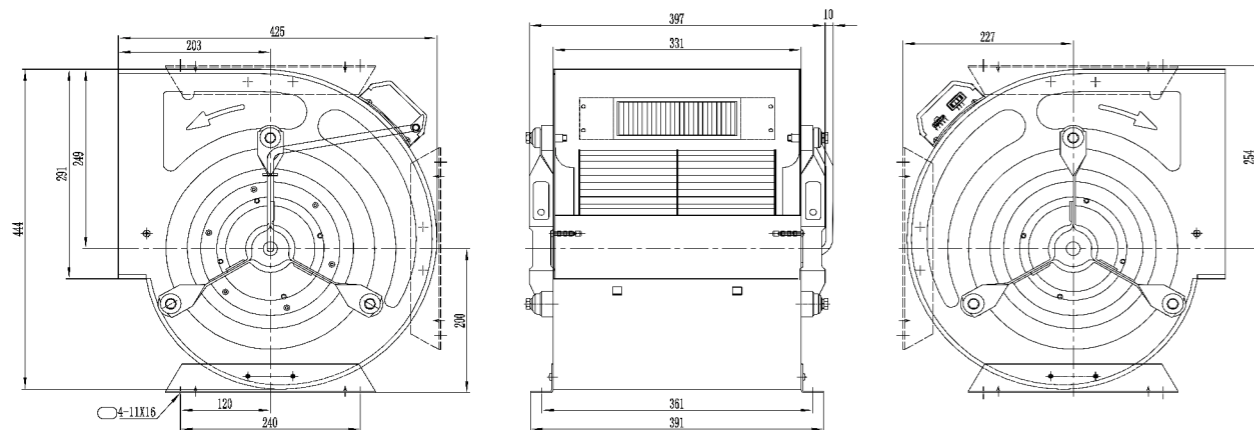

ZQ12-9I(750W)

电机: YZWWSL-750-11
电压范围: 1 ~ 220-240VAC
频率: 50/60Hz
最大转速: 1350rpm
额定电流: 5.8A
重量: 23.2Kg
最大输入功率: 1064W

Motor: YZWWSL-750-11
Voltage range: 1 ~ 220-240VAC
Frequency: 50/60Hz
Max.Speed: 1350rpm
Rated current: 5.8A
Weight: 23.2Kg
Max.Power input: 1064W

性能曲线

Performance Curve

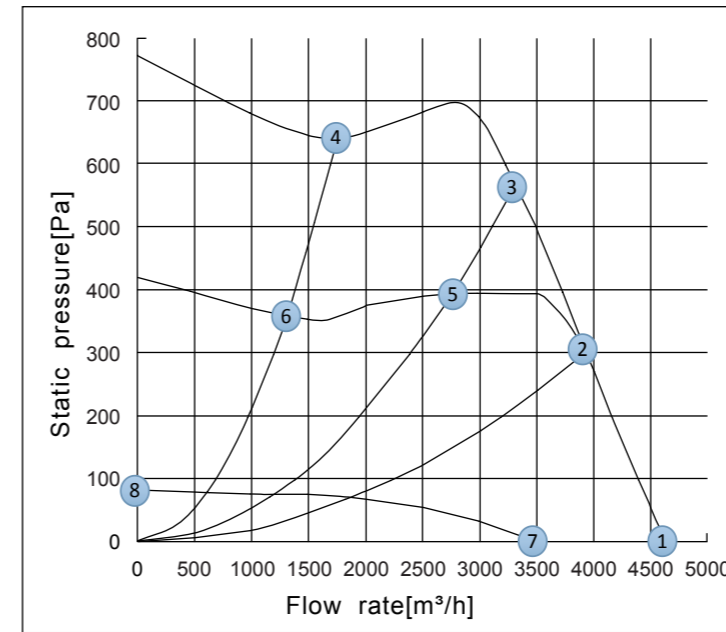

	n[rpm]	Q(m³/h)	P _{st} [Pa]	P _i [W]	I[A]	L _{WA} [dB(A)]	η _{IL} [%]
1	610	4600	0	580	4.35	80.1	23
2	910	3934	299	799	5.74	80.4	49.8
3	1209	3318	564	1008	7.08	79.7	55.8
4	1350	1768	640	755	5.41	78.9	42.4
5	1000	2730	382	570	4.23	75.8	56
6	1000	1350	373	317	2.49	73.5	45
7	450	3505	0	234	1.93	74.2	21.4
8	450	0	81.8	30.5	0.316	63.1	0

外形及安装尺寸

Overall Dimensions

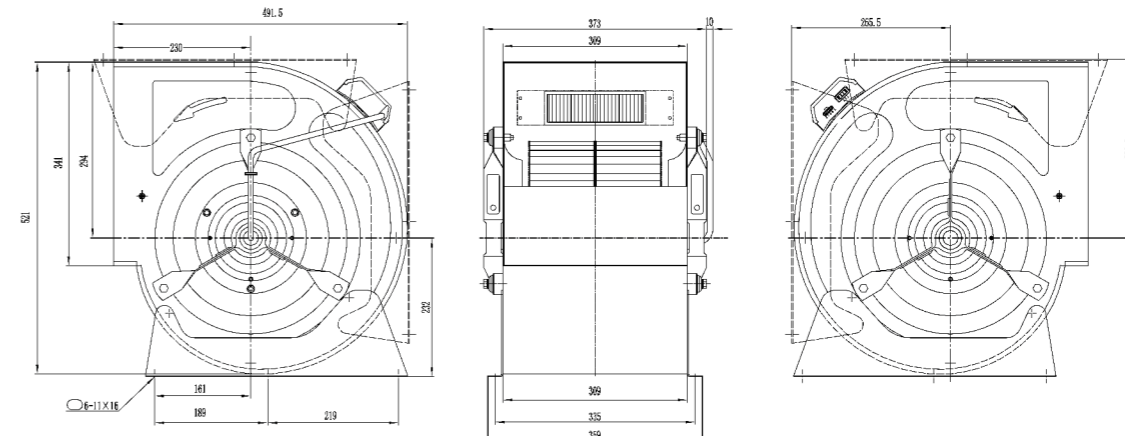



ZQ12-12I(750W)

电机 : YZWWSL-750-11
电压范围 : 1 ~ 220-240VAC
频率 : 50/60Hz
最大转速 : 1350rpm
额定电流 : 5.8A
重量 : 26Kg
最大输入功率 : 1053W

Motor: YZWWSL-750-11
Voltage range: 1 ~ 220-240VAC
Frequency: 50/60Hz
Max.Speed: 1350rpm
Rated current: 5.8A
Weight: 26Kg
Max.Power input: 1053W

性能曲线

Performance Curve

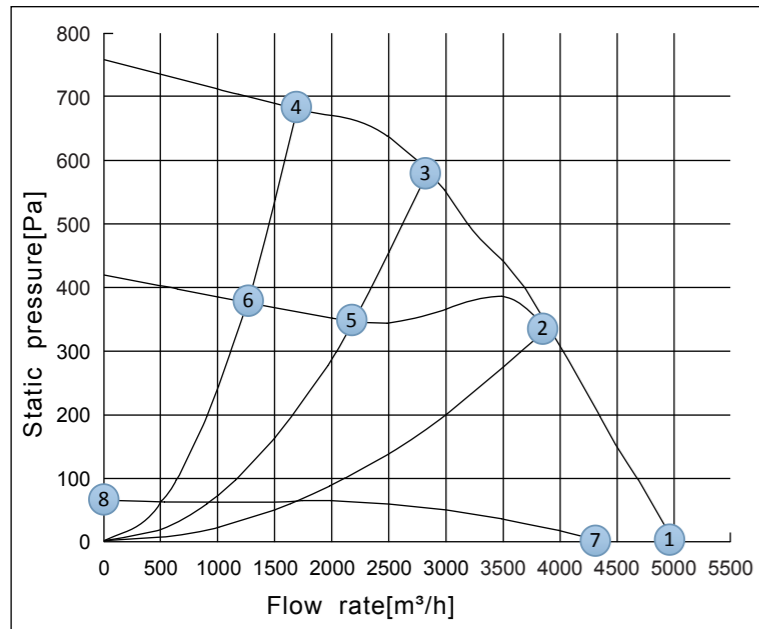

	n[rpm]	Q[m³/h]	P _{st} [Pa]	P _i [W]	I[A]	LWA[dB(A)]	η _{tl} [%]
1	619	4900	0	585	4.32	77.2	33
2	1061	3909	335	818	5.86	77.4	53.2
3	1300	2854	581	1053	7.4	79.6	47.4
4	1350	1710	680	744	5.38	81.5	45.9
5	1000	2200	345	493.5	3.7	74.2	46
6	1000	1260	369	312.5	2.4	75.0	40
7	450	4367	0	332	2.58	73.5	19.1
8	450	0	65.1	33.2	0.365	61.7	0

外形及安装尺寸

Overall Dimensions

